

SW3320 Ver1.3

Version history

No.	Issue Data	Author	Rev	memo
V1.0	2018-09-01	Lu		
V1.1	2018-12-10	Lu		

1. Key Specifications

Module No.	SW3320 Ver1.3	
Module Size	65.91mm x 18.36mm x 17.78mm	
Temperature (Operation)	-20°C to 60°C	
Temperature (Stable Image)	0°C to 50°C	
Assembly technique	SMT	
Object distance	60CM	
PCB printing ink	black	
USB power supply voltage	5V	
interface	USB 2.0,USB 3.0	
Power	USB bus power	
Operating system request	Win XP, Win 7 or android4.1, android5.1, android7.1 and above	
Package	Anti-electrostatic tray	
Sensor Type	1/3" +1/3"	
Array Size	Color camera	Infrared camera
	MJPG resolution 25 fps+ 15fps(2048*1536)	MJPG Full resolution (30 fps)
	RGB	YUY2:
	640*480(15fps)	320*240(30fps)
	800*600(15fps)	640*480(30fps)
	1280*720(9fps)	800*600(10fps)
	1280*960(5fps)	1024*768(5fps)
	1920*1080(5fps)	1280*720(10fps)
	2048*1536(5fps)	1280*960(10fps)
Pixel Size	2.2μm x 2.2μm	
Package	ILCC	
Lens Construction	2G2P +IR	
F/No	2.8 mm	
EFL	2.8mm ±5%	
FOV	100°	
IR Filter	850±10nm	
Support the compression formats	YUV/MJPG	

2.Module Mechanical Dimension

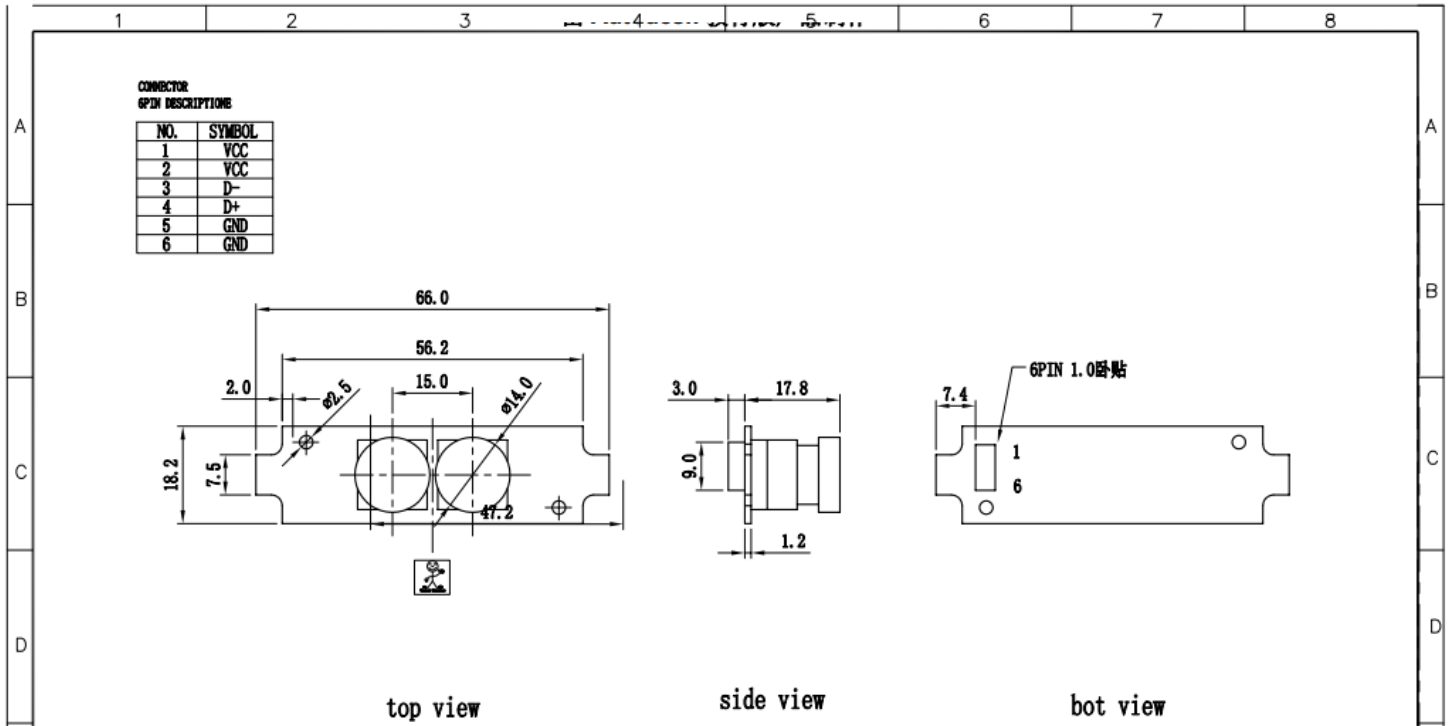

EFL	2.8mm	Array size	2048*1536
F.No.	2.8	Lens size	1/3 inch
View Angle	100 degrees		
Distortion	<-1%		
Chip Type	CMOS NSW3320		

3.Pin Description

Pin Number	Name	Pin Type	Function Description
1	VCC	Power	USB Power Supply +5V
2	VCC	Power	USB Power Supply +5V
3	D-	Data Pin	USB Data Transmission
4	D+	Data Pin	USB Data Transmission
5	GND	GND	System Ground
6	GND	GND	System Ground